

ANSI and RPM FLANGE UNIONS AND FLANGES

How to specify 8767A, 8767B, 8767C, 8767D, and 8767E Flanges.

8767 - -



Option III

S = Single: one flange, one gasket, hardware to accommodate companion flange thickness as follows:
 8767A, 8767B, 8767C: up to 1½"
 8767D, 8767E: up to ¾"

P = Orifice plate: two flanges, two gaskets, hardware to accommodate an orifice plate up to ¾" thick.

U = Union: two flanges, one gasket, hardware.

V = Wafer valve: two flanges, two gaskets, hardware to accommodate the corresponding FivesNA wafer valves: 1136, 45, 46, 55 and 56. (For butterfly and automatic shutoff valves use two "S" assembly flanges.)

H = 8697-7 Orifice holder: two flanges, type A or type C only. Two gaskets, 6 through bolts, washers and nuts. 4 blind hole bolts and washers.

R = Resilient seat valve: two flanges, hardware to accommodate FivesNA 1154 Valve (gaskets not needed).

Option II

Fives North American Pipe Code

Option I

(Product Designation)

A = ANSI Class 150 steel, slip-on welding, flat face

B = ANSI Class 150 steel, slip-on welding, raised face (except for 1154 resilient seat valves, not suitable as a companion flange for FivesNA products because of raised face)

C = ANSI Class 150, steel, screwed, flat face

D = Fabricated low pressure air--RPM drilling

NOTE: 500 F service is the temperature limitation for standard gaskets. For higher temperature service consult Fives North American.

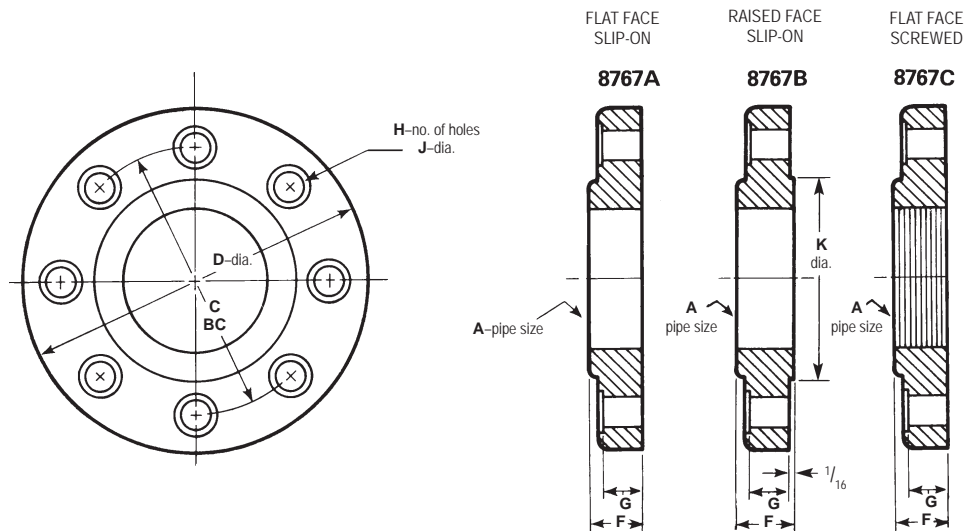

8767A and 8767B ANSI CLASS 150 STEEL SLIP-ON WELDING FLANGES

Fives North American can supply ANSI (American National Standards Institute) Class 150 steel, slip-on welding flanges. 8767A Flat Face Flanges can be used (for example) as companion flanges with FivesNA 1518 or 1519 Automatic Shutoff Valves and FivesNA wafer valves 14" and under when slip-on welding connections are preferred. 8767B Flanges with raised face make suitable unions in fuel pipe lines.

Flange designation	dimensions in inches							Flange only wt, lb
	A	C	D	F	G	H	J	
8767A-01	1/2	2 3/8	3 1/2	5/8	7/16	4	5/8	1
8767A-0	3/4	2 3/4	3 7/8	5/8	1/2	4	5/8	2
8767A-1	1	3 1/8	4 1/4	1 1/16	9/16	4	5/8	2
8767A-2	1 1/4	3 1/2	4 5/8	1 3/16	5/8	4	5/8	3
8767A-3	1 1/2	3 7/8	5	7/8	1 1/16	4	5/8	3
8767A-4	2	4 3/4	6	1	3/4	4	3/4	5
8767A-5	2 1/2	5 1/2	7	1 1/8	1 1/16	4	3/4	8
8767A-6	3	6	7 1/2	1 3/16	3/4	4	3/4	8
8767A-7	4	7 1/2	9	1 5/16	15/16	8	3/4	12
8767A-8	6	9 1/2	11	1 9/16	1	8	7/8	19
8767A-9	8	11 3/4	13 1/2	1 3/4	1 1/8	8	7/8	30
8767A-10	10	14 1/4	16	1 15/16	1 3/16	12	1	43
8767A-12	12	17	19	2 3/16	1 1/4	12	1	64
8767A-14	14	18 3/4	21	2 1/4	1 3/8	12	1 1/8	90
8767A-16	16	21 1/4	23 1/2	2 1/2	1 7/16	16	1 1/8	98
8767A-18	18	22 3/4	25	2 11/16	1 9/16	16	1 1/4	130
8767A-20	20	25	27 1/2	2 7/8	1 11/16	20	1 1/4	165

Flange designation	dimensions in inches							Flange only wt, lb	
	A	C	D	F	G	H	J		K
8767B-01	1/2	2 3/8	3 1/2	1 1/16	7/16	4	5/8	1 3/8	1
8767B-0	3/4	2 3/4	3 7/8	1 1/16	1/2	4	5/8	1 1/16	2
8767B-1	1	3 1/8	4 1/4	3/4	9/16	4	5/8	2	2
8767B-2	1 1/4	3 1/2	4 5/8	7/8	5/8	4	5/8	2 1/2	3
8767B-3	1 1/2	3 7/8	5	1 5/16	1 1/16	4	5/8	2 7/8	3
8767B-4	2	4 3/4	6	1 1/16	3/4	4	3/4	3 5/8	5
8767B-5	2 1/2	5 1/2	7	1 3/16	1 1/16	4	3/4	4 1/8	8
8767B-6	3	6	7 1/2	1 1/4	3/4	4	3/4	5	8
8767B-7	4	7 1/2	9	1 3/8	1 5/16	8	3/4	6 3/16	12
8767B-8	6	9 1/2	11	1 5/8	1	8	7/8	8 1/2	19
8767B-9	8	11 3/4	13 1/2	1 13/16	1 1/8	8	7/8	10 5/8	30
8767B-10	10	14 1/4	16	2	1 3/16	12	1	12 3/4	43
8767B-12	12	17	19	2 1/4	1 1/4	12	1	15	64
8767B-14	14	18 3/4	21	2 5/16	1 3/8	12	1 1/8	16 1/4	90
8767B-16	16	21 1/4	23 1/2	2 9/16	1 7/16	16	1 1/8	18 1/2	98

8767C ANSI CLASS 150 STEEL SCREWED FLAT FACE FLANGES

These also can be used as companion flanges with Fives North American 1518 Manual Reset or 1519 Automatic Valves and FivesNA wafer valves 14" and under.

Flange designation	dimensions in inches							Flange only wt, lb
	A	C	D	F	G	H	J	
8767C-01	1/2	2 3/8	3 1/2	5/8	7/16	4	5/8	1
8767C-0	3/4	2 3/4	3 3/8	5/8	1/2	4	5/8	2
8767C-1	1	3 1/8	4 1/4	1 1/16	9/16	4	5/8	2
8767C-2	1 1/4	3 1/2	4 5/8	1 3/16	5/8	4	5/8	3
8767C-3	1 1/2	3 3/8	5	7/8	1 1/16	4	5/8	3
8767C-4	2	4 3/4	6	1	3/4	4	3/4	5
8767C-5	2 1/2	5 1/2	7	1 1/8	1 1/16	4	3/4	7
8767C-6	3	6	7 1/2	1 3/16	3/4	4	3/4	7 1/2
8767C-7	4	7 1/2	9	1 5/16	1 5/16	8	3/4	11 1/4
8767C-8	6	9 1/2	11	1 9/16	1	8	7/8	16 3/4

8767D FABRICATED LOW PRESSURE AIR SLIP-ON FLANGES, RPM DRILLING

The following FivesNA equipment matches RPM dimensions in 16" and up:

Wafer Valves:
1145, 1146, 1155, 1156

Magna-Flame™ Burners
4795, 5795, 6795, 4796, 5796, 6796

VHP Burners:
4818, 5818, 6818

Hot Air Burners:
4819, 5819, 6819, 4819- -A, 6819- -A

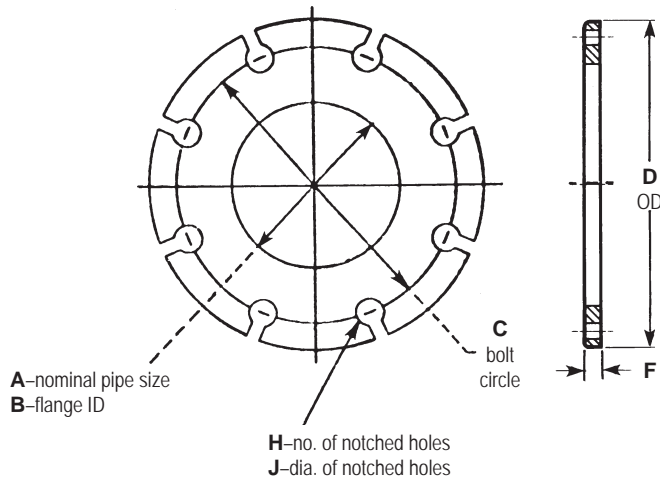

Flange designation	dimensions in inches							wt, lb
	A	B†	C	D	F	H	J	
8767D-6	3	3 9/16	4 3/4	6	3/8	4	5/8	2
8767D-7	4	4 9/16	5 15/16	7	3/8	8	5/8	3
8767D-8	6	6 1 1/16	7 7/8	9	1/2	8	5/8	6
8767D-9	8	8 3/4	10	11	1/2	8	5/8	7
8767D-10	10	10 7/8	12 1/4	14	1/2	12	3/4	12
8767D-12	12	12 7/8	14 1/4	16	1/2	12	3/4	14
8767D-14	14	14 7/8	16 1/4	18	5/8	12	3/4	20
8767D-16	16	16 1/8	19 1/4	21 1/4	5/8	16	3/4	31
8767D-18	18	18 1/8	21 1/4	23 1/4	5/8	16	3/4	36
8767D-20	20	20 1/8	23 1/8	25 1/4	5/8	20	3/4	38
8767D-22	22	22 1/8	26	28 1/4	5/8	20	3/4	51
8767D-24	24	24 1/8	27 3/4	30	3/4	20	3/4	64
8767D-26	26	26 1/4	29 3/4	32	3/4	24	7/8	66
8767D-28	28	28 1/4	31 3/4	34	3/4	28	7/8	71
8767D-30	30	30 1/4	33 3/4	36	3/4	28	7/8	75
8767D-32	32	32 1/4	35 3/4	38	3/4	28	7/8	80
8767D-34	34	34 1/4	37 3/4	40	3/4	32	7/8	85
8767D-36	36	36 1/4	39 3/4	42	3/4	32	7/8	89
8767D-38	38	38 1/4	41 3/4	44	3/4	32	7/8	94
8767D-40	40	40 1/4	43 3/4	46	3/4	36	7/8	99
8767D-42	42	42 1/4	45 3/4	48	3/4	36	7/8	103
8767D-44	44	44 1/4	47 3/4	50	3/4	40	7/8	108
8767D-46	46	46 1/4	49 3/4	52	3/4	40	7/8	112
8767D-48	48	48 1/4	51 3/4	54	3/4	44	7/8	117

† Based on standard steel pipe. For other types of pipe, alter B dimension to suit.

8767E FABRICATED LOW PRESSURE AIR SLIP-ON FLANGES with ANSI 150 TYPE* DRILLING

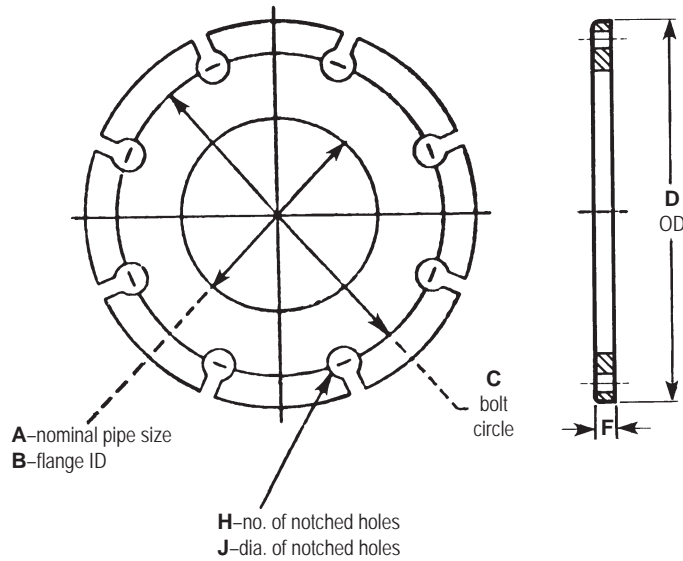

Flange designation	dimensions in inches						
	A	B	C	D	F	H	J
8767E-5	2½	2 ¹⁵ / ₁₆	5½	7	¾	4	¾
8767E-6	3	3 ⁹ / ₁₆	6	7½	¾	4	¾
8767E-7	4	4 ⁹ / ₁₆	7½	9	¾	8	¾
8767E-8	6	6 ¹ / ₁₆	9½	11	½	8	⅞
8767E-9	8	8 ¹ / ₁₆	11¾	13½	½	8	⅞
8767E-10	10	10 ⁷ / ₈	14¼	16	½	12	1
8767E-12	12	12 ⁷ / ₈	17	19	½	12	1
8767E-14	14	14 ³ / ₁₆	18¾	21	⅝	12	1 ¹ / ₈
8767E-16	16	16 ³ / ₁₆	21¼	23½	⅝	16	1 ¹ / ₈
8767E-18	18	18 ³ / ₁₆	22¾	25	⅝	16	1 ¹ / ₄
8767E-20	20	20 ³ / ₁₆	25	27½	⅝	20	1 ¹ / ₄
8767E-22	22		Unavailable--see 8767D Flange data				
8767E-24	24	24¼	29½	32	¾	20	1 ³ / ₈
8767E-26	26		Unavailable--see 8767D Flange data				
8767E-28	28						
8767E-30	30	30¼	36	38¾	¾	28	1 ³ / ₈

***Non-ANSI rated for low pressure combustion air only.**

DIMENSIONS SHOWN ARE SUBJECT TO CHANGE. PLEASE OBTAIN CERTIFIED PRINTS FROM FIVES NORTH AMERICAN COMBUSTION, INC. IF SPACE LIMITATIONS OR OTHER CONSIDERATIONS MAKE EXACT DIMENSION(S) CRITICAL.

WARNING: Situations dangerous to personnel and property may exist with the operation and maintenance of any combustion equipment. The presence of fuels, oxidants, hot and cold combustion products, hot surfaces, electrical power in control and ignition circuits, etc., are inherent with any combustion application. Parts of this product may exceed 160F in operation and present a contact hazard. Fives North American Combustion, Inc. urges compliance with National Safety Standards and insurance Underwriters recommendations, and care in operation.

Fives North American Combustion, Inc. - 4455 East 71st Street - Cleveland, OH 44105 USA - Phone 216.271.6000
 Fax 216.641.7852 - email: fna.sales@fivesgroup.com - www.fivesgroup.com/fivesna