



H3660 Line Scan Sensor



- **Width, edge and center position sensing**
- **Integrated sensor array and light source**
- **Quick setup, simple operation**
- **Analog control output**
- **Field of view up to 875 mm (34.4")**
- **Direct plug connector at controller**
- **Accurate width measurement**
- **Polarizing optics for clear film webs**

The H3660 Line Scan Sensor is an edge, centerline, or width detecting sensor. Using IR light, it illuminates a retroreflective tape (reflector), which is placed behind the web. The light returned by the reflector is imaged onto a linear array within the sensor. Any web, that is placed between the reflector and the sensor, is "seen" dark in front of a bright background.

An integrated microcontroller analyzes the signal from the array and detects the exact position of the web's edges. Depending on the previously set measuring mode, it generates an analog output signal.

The following modes can be set using buttons on the rear of the sensor.

- Edge mode: Position of the first edge from the left or the first edge from the right.
- Center mode: Center position of the web.
- Width mode: Sum of all dark areas or distance from the first to the last edge.

DIMENSIONS

Inches (millimeters)

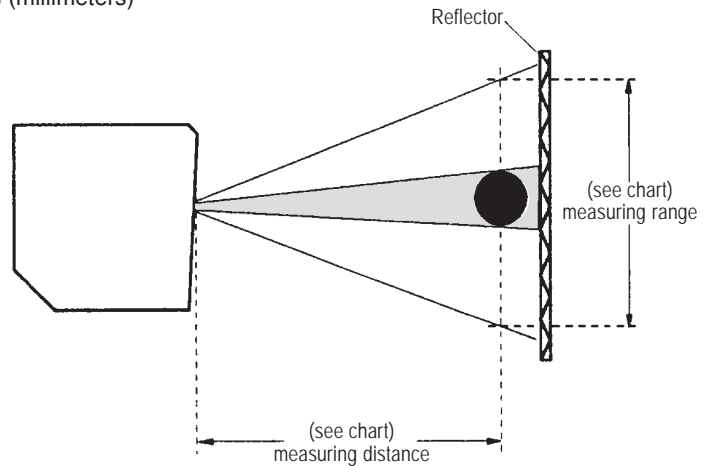
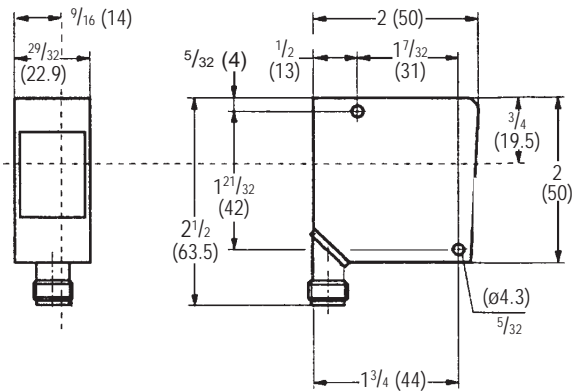

Model	Measuring Range, inches (mm)	Measuring Distance, inches (mm)	Resolution inches (mm)	Smallest Detectable Object, inches (mm)
H3660-030 H3660-030/P	1.18 (30)	1.97 (50)	.0012 (.03)	.012 (.3)
H3660-150 H3660-150/P	5.91 (150)	7.8 (200)	.006 (.15)	.047 (1.2)
H3660-350 H3660-350/P	13.78 (350)	19.69 (500)	.016 (.4)	.157 (4)
H3660-875	15.75 (400) to 34.45 (875)	25.2 (640) to 55.12 (1400)	.019 (.49) to .042 (1.1)	.34 (8.5) to .74 (18.7)

TECHNICAL DATA

Analog output 0.4 - 2.0 V dc or 4-20 mA (depending on cable selection)
 Power 15 to 28 V dc at 150 mA or less (supplied by SimPlex™ controller)
 Resolution 0.1% of measuring range
 Linearity better than 1%
 Sampling frequency 120/second or greater

Light source infrared, 880 nm
 Operating temperature range 0-55 C (32-130 F)
 Housing material zinc die cast
 Environmental rating IP 67
 Optical window material glass

ORDERING INFORMATION

Part number	Description
H3660-030	Line Scan sensor with 30 mm field of view
H3660-150	Line Scan sensor with 150 mm field of view
H3660-350	Line Scan sensor with 350 mm field of view
H3660-875	Line Scan sensor with 400 to 875 mm field of view
H3660-030/P	Line Scan sensor with 30 mm field of view and polarized optics for clear film
H3660-150/P	Line Scan sensor with 150 mm field of view and polarized optics for clear film
H3660-350/P	Line Scan sensor with 350 mm field of view and polarized optics for clear film
H3660-6415-15	15 foot power cable, H3660 to SimPlex
H3660-6600-15	15 foot power cable, H3660 to H6600 (with spadelugs)
H3660-4-20MA-15	15 foot power cable, 4-20 mA output (with spadelugs)
H3660-RFL-030	Reflector assembly for H3660-030 and H3660-030/P
H3660-RFL-150	Reflector assembly for H3660-150 and H3660-150/P
H3660-RFL-350	Reflector assembly for H3660-350 and H3660-350/P
H3660-RFL-875	Reflector assembly for H3660-875
H3660-RT50-5	Roll of Retro-Reflective Tape (5 meters × 50 mm)

International Headquarters
North American Mfg. Co., Ltd.

4455 EAST 71st STREET, CLEVELAND, OH 44105-5600 USA
 Tel: 216.271.6000 Fax: 216.641.7852
 email: sales@namfg.com • www.namfg.com

North American Mfg. (Canada) Inc.

540 PIERCEY RD., BOLTON, ONT. L7E 5B4, CANADA
 Tel: 905.857.3337 Fax: 905.857.0304